

Technical data

Supply Voltage: 220-240 V~, 50Hz | Operational Voltage: 25-40V DC

Bulb Type: 106526: 40W LED SMD 4000K
 106527: 40W LED SMD 6000K

This product contains a light source of energy efficiency class **E**.

  Non-replaceable light source |  Replaceable control gear by a professional

 Conformity with all relevant UKCA Directive requirements.

 Conformity with all relevant EC Directive requirements.

 The power supply is double insulated and does not require connection to an earth circuit.

 The part of panel light is Class III product - designed to be supplied via a transformer.

 Waste electrical products should not be disposed of with household waste. Please recycle where facilities exist. Check with your Local Authority or local store for recycling advice.

 This product is not suitable for dimming.

Care and Safety

Live Voltages may be present in this unit even when turned off or when completely disconnected.
 We recommend cleaning with a soft dry cloth. Do not use solvents or abrasive cleaners as these could damage the finish.
 For your safety, always switch off the power supply before cleaning.



Thank you for purchasing this light fitting. Please read the instruction carefully before use to ensure safe and satisfactory operation of this product. Please retain these instruction for future reference.

Warning

 This light fitting is double insulated and does not require connection to an earth circuit.

Please read these instructions carefully before commencing any work.

This unit must be fitted by a competent and qualified electrician.

Install in accordance with the IEE Wiring regulations and current Building Regulations.

Check the pack and make sure you have all the parts listed.

To prevent electrocution switch off at the mains supply before installing or maintaining this fitting. Ensure other persons cannot restore the electrical supply without your knowledge. If you any doubt please consult a qualified electrician.

This light fitting should be connected to a fused circuit.

If replacing an existing fitting, make a careful note of the connections.

The part of the panel light at Safety Extra Low Voltage (DC25-40V) via a transformer. Never connect the light fittings directly to the mains without using a transformer.

Waste electrical products should not be disposed of with household waste. Please recycle where facilities exist. Check with your local authority or retailer for recycling advice.

Layout

Plan the desired layout of these fittings carefully, ensuring the cables will reach the distances between the LED Driver and each light fitting.

Ensure the there is adequate ventilation for the LED Driver.

Avoid locating any cables in positions that would cause a hazard. Position cables and junction boxes (not supplied) away from areas where they may be at risk from being cut, trapped or damaged.

The mains supply cable must have a minimum cross section area of 1.0mm².

Cables must be protected using suitable conduit or plastic trunking.

These fittings are designed to be fitted into a suspended ceiling.

Installation

Existing fittings must be completely removed before installation of a new product. Before removing the existing fitting, carefully note the position of each set of wires.

Note that the switch is turned off before installation.

- If there is a ceiling tile in position then ensure that it is removed.
- Pull the mains wire through the ceiling to connect to connection block (not supplied) to wire with driver cable.
- Connect driver cable to panel using push & twist connector as shown below (**Fig. 5**).
- Place panel fitting into the ceiling. Ensure that the product is sitting properly on the suspended ceiling frame.
- Replace fuse or circuit breaker and switch on. Your light is now ready for use.

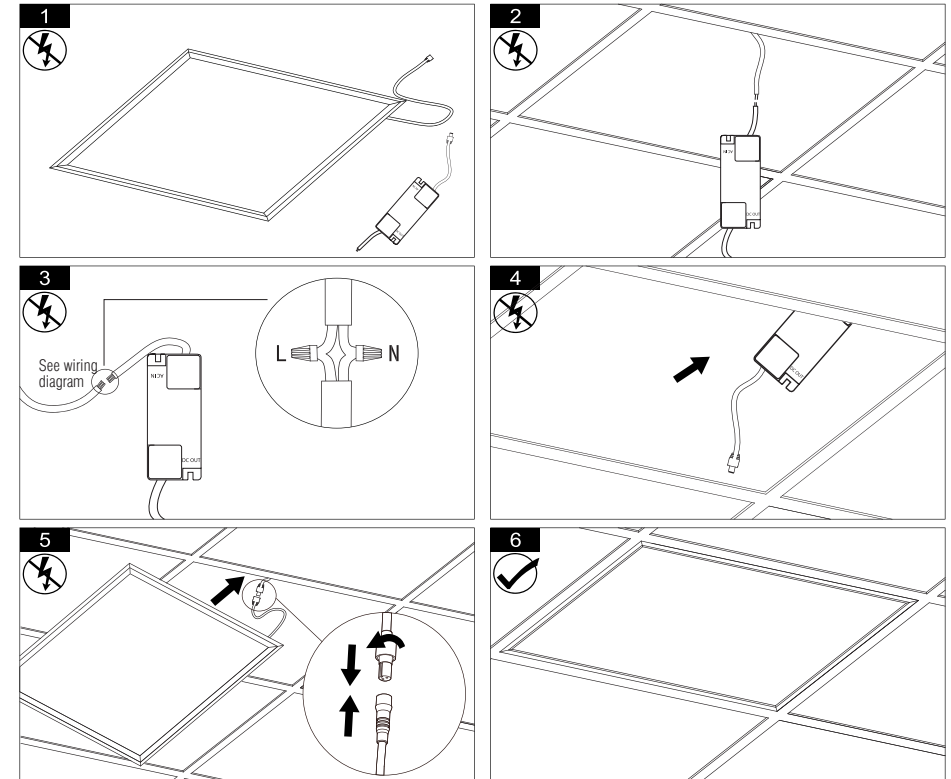

Wiring

Having correctly identified the wiring from your existing light fitting and connect to the connection block (not supplied) via the LED driver in the following way:

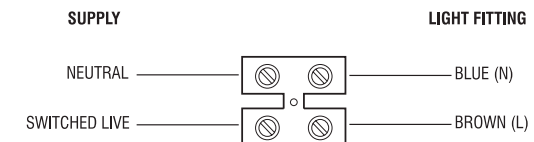

Check that...

- You have correctly identified the wires.
- The connections are tight.
- No loose strands have been left out of the connection block.